

Reflecta Graphic Pod & Lightbox



2m Reflecta Pod

A range of graphics pods and lightboxes, perfect for demonstration units or for instore displays and exhibitions.

features & benefits

- Multi-purpose promotional unit
- Graphic pod or Illuminated Lightbox
- Strong and stylish ellipse design
- 1 metre or 2 metre heights
- Single or double sided
- Packs flat for transit and storage
- Require 3mm thick substrates - not included

technical information

- *Lightbox complete with TFL cool fluorescent tube(s), 1.5metre mains lead & plug*
- *Recommended graphic materials:*
3mm thick Opel acrylic for Lightboxes
3mm Foamex for Graphic Pods
- *Suitable for indoor use only*



1m Reflecta Pod

hardware specifications	graphic specifications	additional info
<p>Assembled Dimensions (mm):</p> <p>2m units (MR912 & MR102) 2000 (h) x 1100 (w) x 400 (d) approx. MR912 Lightbox Weight: 10.5kg approx. MR102 Graphic Pod Weight: 9kg approx</p> <p>1m units (MR911 & MR101) 1000 (h) x 1100 (w) x 400 (d) approx. MR911 Weight: 8.5kg approx. MR101 Weight: 7kg approx.</p>	<p>Graphic Dimensions (mm):</p> <p>2m units (MR912 & MR102) 2000 (h) x 1000 (w) x 3 thick approx. Visible Graphic Dimensions (mm): 1975 (h) x 980 (w) approx.</p> <p>1m units (MR911 & MR101) 1000 (h) x 1000 (w) x 3 thick approx. Visible Graphic Dimensions (mm): 975 (h) x 980 (w) approx.</p>	<p>Availability:</p> <p>Beech base and top, anodised aluminium posts.</p> <p>Weights detailed do not include graphic substrates or transit packaging.</p>

Assembly Instructions



Kit includes: Top, Base, Aluminium posts (x2) M10 bolts (x4), M8 screws (x2) and lighting post/ tubes (if applicable)
(Note graphic substrates are not included)



1
Insert the 1st aluminium post into the base.

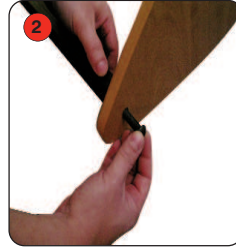

2
Secure the post using 1 M10 bolt, tighten using an M10 Allen key. Repeat steps 1 & 2 for 2nd post.



3
Attach the lighting post (if applicable) to the base using 1 M8 flat head screw.



4
Tighten the M8 screw using a flat head screwdriver.

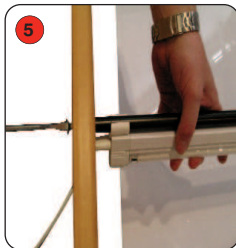

5
Repeat steps 1 to 4 to attach the top. Only loosely affix the top to the posts.



6
Stand the unit up.

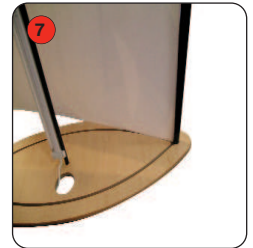

7
Place the graphic substrate into the base channel.



8
Feed the vertical edge of the graphic substrate into the 1st aluminium post.



9
If required, loosen the top fixings. Fit the remainder of the graphic substrate into the 2nd post.



10
Fit the the graphic substrate into the top and into the 2nd aluminium post.

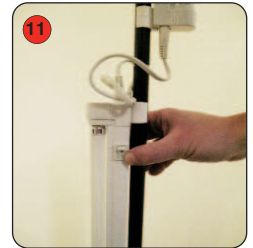

11
Ensure the fluorescent lights are switched on. (If applicable)

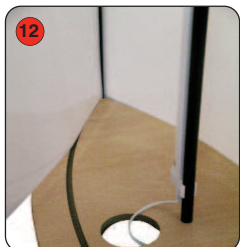

12
Feed the 2nd graphic substrate into the base channel.



13
Fit the the graphic substrate into the top and into the 2nd aluminium post.

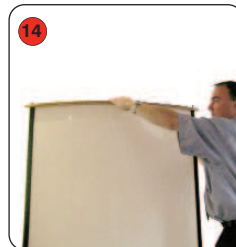

14
Adjustment may be necessary to locate the graphic substrate into the top channel.

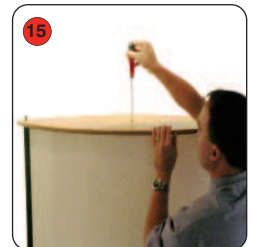

15
Tighten the top fixings using a flat head screwdriver and M10 Allen key.



features & benefits

- Graphic pods show graphics in natural lighting
- Reflecta lightboxes illuminate graphics with backlighting and light diffusing panels.
- Double sided
- Simple to assemble and change graphics
- Protective acetate supplied to protect graphics
- Stable oversize base



technical information

- Lightboxes use standard 35w & 18w fluorescent tubes
- Recommended graphic material: 200 micron Duratrans or equivalent
- Suitable for indoor use only

Product Size	graphic specifications	additional info
Reflecta graphic Pod - (MR103) H842 x W560 x D280	H800 x W400	Weight: 5kg
Reflecta graphic Pod - (MR104) H1572 x W560 x D280	H1530 x W400	Weight: 7kg
Reflecta Lightbox - (MR914) H842 x W560 x D280	H800 x W400	Weight: 10kg
Reflecta Lightbox - (MR915) H1572 x W560 x D280	H1530 x W400	Weight: 12kg

Assembly Instructions

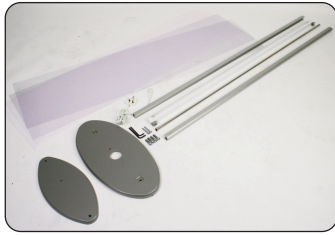

Graphic Pod Kit includes: Base, frame extrusions, top, screws x4, allen key, light defusing panels x2, protective acetate sheets x2

Lightbox kit additions: Lightpole, fluorescent tube & light, power cable, screws x 6, allen keys x2

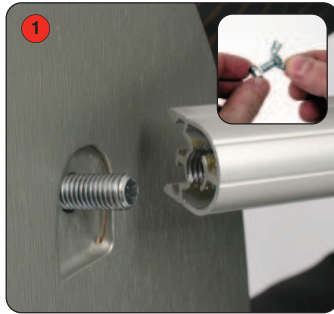

Lightbox & Graphic Pod: Fix extrusions to base with screws

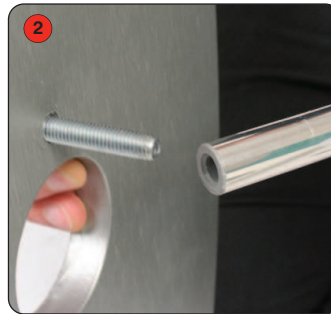

Lightbox: Fix lightpole mounting to base



Lightbox & Graphic Pod: Fix extrusions to top with screws



Lightbox: Insert power cable through base



Lightbox: Plug in fluorescent light



Lightbox: Clip light to light pole mounting

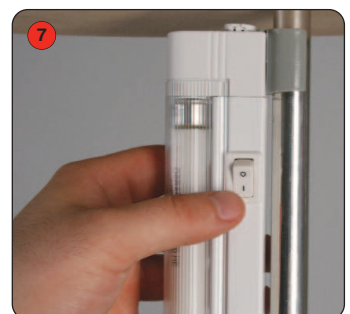

Lightbox: Turn on the fluorescent light switch before adding the graphics



Lightbox & Graphic Pod: Insert light defusing panels, graphics, and protective sheets, between the frame extrusions

Important note: If the external flexible cable is damaged it shall be exclusively replaced by the manufacturer or his service agent or similar qualified person.

Other products in our Reflecta range include:



Reflecta D

A high impact light box display solution, just add your own graphics. Spring loaded mechanism for easy change of graphics. Wall fixing, portrait or landscape



Reflecta Pod

A range of graphics pods perfect for demonstration units or instore displays and exhibitions.



Reflecta Pro

An unusual and subtle way of creating an eye catching display. The Reflecta Pro light box provides you with a simple and cost effective solution.